

# CONCRETE MASTERS INC.

23 YEARS OF DEDICATED AND EXCELLENT SERVICE





# MISSION

To provide products and services for the construction industry that reflects our continuous commitment to excellence, quality, and integrity in collaboration with our business partners.

We constantly develop our organization to be a model of responsible corporate citizenship and employee growth and satisfaction while ensuring a fair return to our shareholders.

# VISION

The leading ready mix concrete company that continuously delights our customers and business partners in areas of product quality, service, business, growth, safety, environmental preservation and social responsibility while fostering employee satisfaction.

# OUR PROMISE TO OUR CLIENTS

FOR CONSISTENT QUALITY

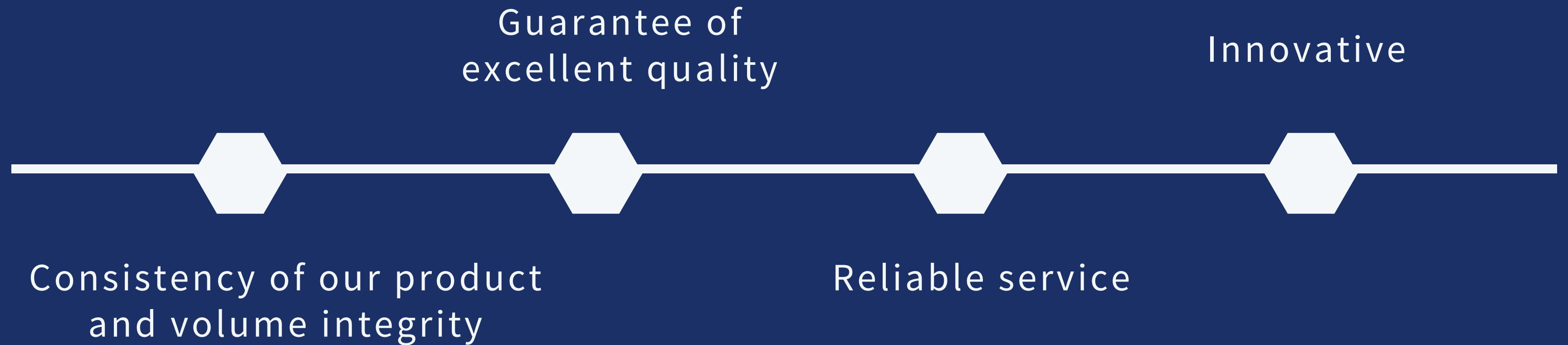

# ABOUT US



Established in 1996, CMI was originally established as a major partner in building a new metropolis: The Fort Bonifacio Global City. Four Months after the property sites were turned over to CMI, the company established a turnkey pre-mixed concrete company.



Today, the operations team is staffed with the BEST engineering professionals in the pre-mixed concrete industry. CMI is ready ready to take on newer and bigger challenges. The company now operates within Mega Manila and nearby provinces.



CMI's pioneering spirit and innovative approach is made possible by the commitment of its dedicated team of professionals, skilled workers and of course the support of our clients and business partners.



# CORE VALUES

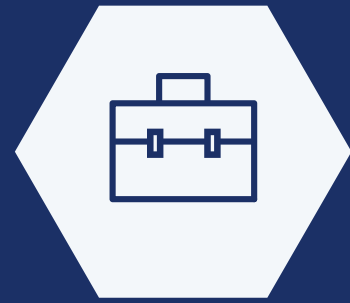

COMMITMENT



RESPECT



INTEGRITY

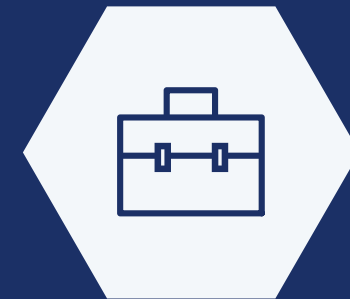

OPENNESS



TEAMWORK



LOYALTY



# BATCH PLANT FACILITIES

# TAGUIG PLANT





**PLANT NO.1:** Batch Tech/SICOMA  
(Made in Italy/singapore)



**CEMENT:** Six (6) silos  
with 18,000 bags  
(720 tons) capacity



**PLANT NO.2:** Kabag/Wiggert Co.  
(Made in Germany)



**TYPE:** Central (Wet)  
Mix batch plants (Fully Automated)



**FLY ASH:** Two (2) with  
240 tons capacity



**COMBINED RATED CAPACITY:** Two  
hundred (200) Cubic meters/hour



**AGGREGATE:**

**Coarse aggregates-** 37.5mm, 19.0mm, 9.5mm (100% crushed basalt mountain quarry)

**Fine Aggregate-** vibrated washed sand

Four (4) aggregate stockpile with a capacity of 2,000 cubic meter per stockpile.





# BATCH PLANT FACILITIES

# MINDANAO AVE. PLANT

Valenzuela City





**PLANT NO.1: ZOOMLION**  
(Made in China)



**CEMENT:** 3 silos with  
15,000 bags (600 tons)  
capacity



**TYPE:** Central (Wet)  
Mix batch plants (Fully Automated)



**FLY ASH:** 1 silo with  
200 tons capacity



**RATED CAPACITY:** Ninety (90)  
Cubic meters/hour



**AGGREGATE:**

Coarse aggregates - 37.5mm, 19.0mm, 9.5mm (100% crushed basalt,  
mountain quarry)

Fine aggregates - Vibrated washed sand  
- Manufactured sand (S-3)

Four (4) aggregate stockpiles with a capacity of 2,500 cubic meters  
per stockpile

# TRANSIT MIXER

ZOOMLION 8CU.M  
30 UNITS

ZOOMLION 9CU.M  
27 UNITS

IVECO 12CU.M  
15 UNITS

# BATCH PLANT EQUIPMENT



## PUMPCRETE UNITS

CIFA 42M BOOM TYPE	1 UNIT
CIFA 38M BOOM TYPE	1 UNIT
IZUZU 38M BOOM TYPE	1 UNIT
ZOOMLION 37M BOOM TYPE	1 UNIT
ZOOMLION CITIPUMP (TRUCK MOUNTED)	3 UNITS
ZOOMLION LINE PUMP (STATIONARY TYPE)	7 UNITS

## PAYLOADER

JCB	2 UNITS
CATERPILLAR	1 UNIT
LIUGONG	6 UNITS

# CENTRAL LABORATORY

LOCATION:  
AFP-RSBS INDUSTRIAL PARK, TAGUIG  
METRO MANILA PHILIPPINES

## TESTS CONDUCTED



Physical test for aggregates



Physical test for cements



Compressive strength test for  
cylinder samples  
(Up to 12,000 PSI strength)



Trial mix with monitoring and  
testing fresh concrete



# CENTRAL LABORATORY

LOCATION:

AFP-RSBS INDUSTRIAL PARK, TAGUIG  
METRO MANILA PHILIPPINES

## TRIAL MIX MONITORING AND TESTING FRESH CONCRETE



Slump retention, 30 min. (2x)



Yield, Unit Weight



Air Content



Temperature



Setting

# CENTRAL LABORATORY

LOCATION:

AFP-RSBS INDUSTRIAL PARK, TAGUIG  
METRO MANILA PHILIPPINES

## COMPRESSIVE STRENGTH



7 days



14 days



28 days



## AGGREGATES



G1 for pavements



3/4 for mid-range concrete



3/8 for high range, self consolidating concrete

## EARLY STRENGTH CONCRETE



From 16 hrs, 24 hrs, 3 days concrete up to 56 days curing period

# PRODUCT DEVELOPMENT

## ON-GOING DEVELOPMENT



14,000 PSI up to 16,000 PSI concrete



Light weight concrete



Sulfate resistant concrete



Colored concrete

## CURRENT DESIGN MIXES



1500 PSI up to 12,000 PSI concrete



Ordinary design mixes, Pumpcrete design and Self compacting concrete (SCC)

# **LIST OF COMPLETED AND ONGOING PROJECTS**



# EEI CORPORATION

## ONGOING PROJECTS

- Grand Hyatt
- Season Residences
- SEMME
- Skyway Pandacan
- Torre Lorenzo
- Light 2 Residences
- Grand Midori
- Glam Residences
- Ice Tower
- South Skyway Extension
- MRT 7
- Skyway Q.C
- I Met

# COMPLETED PROJECTS



RCBC Bank  
Global City



Admiral Bay Suites



Coast Residences



# COMPLETED PROJECTS

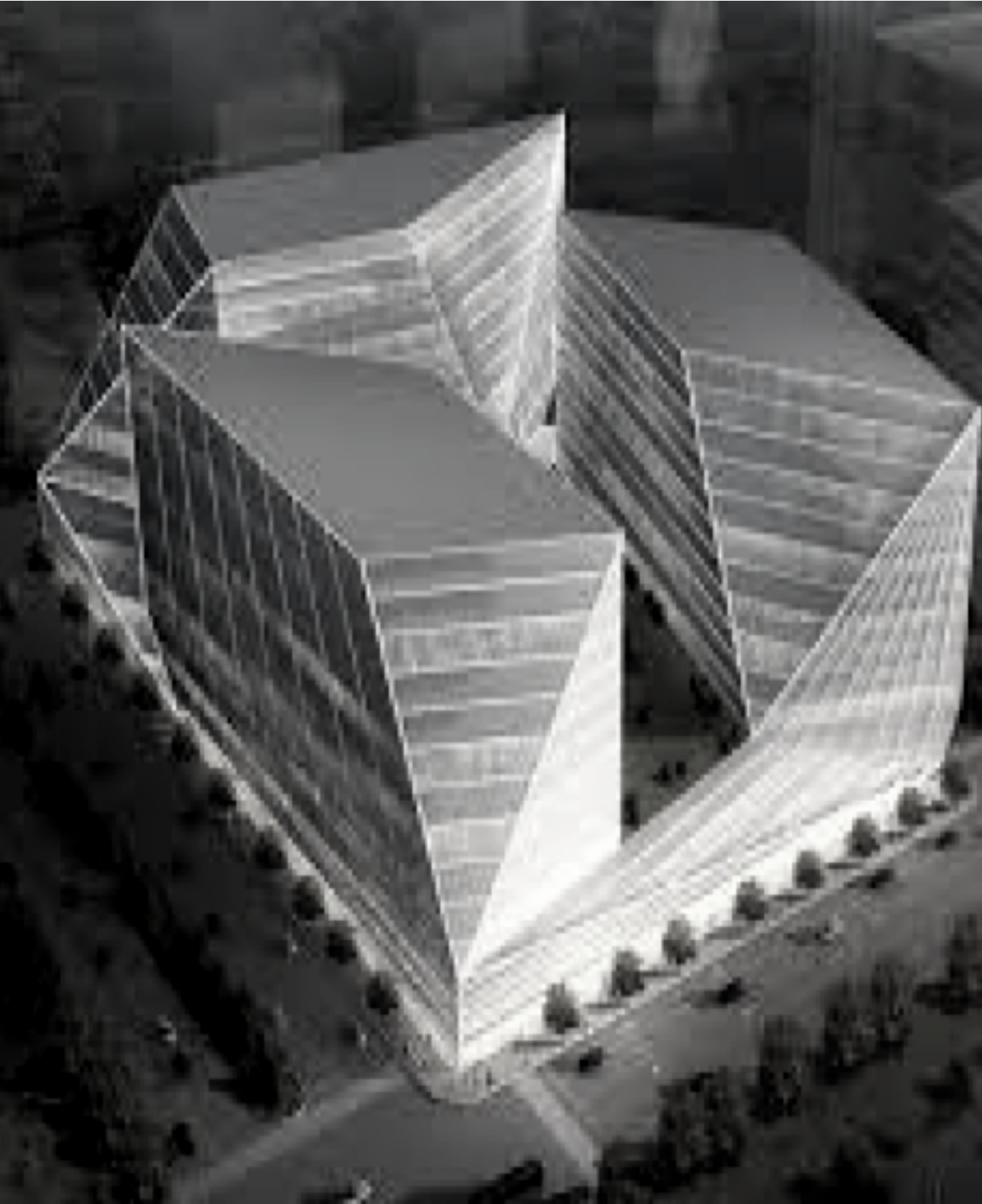

4ECom Center



Pacific Plaza Towers



Beacon Tower

# DDT KONSTRACT, INC.

## ONGOING PROJECTS

- Shore 3
- Bayshore
- Grandwest Side Hotel
- Park McKinley West
- MOA Expansion PH 5



# COMPLETED PROJECTS



Okada Manila (MBRT)



# COMPLETED PROJECTS



Trion Tower 1



Globe Telecom



Anchorland  
Solemارة Suites 1



# COMPLETED PROJECTS



Light Residences



Shell Residences



BDO Tower



# MEGAWIDE

## ONGOING PROJECTS

- 88 MLD
- International Finance Center
- World Wide Plaza
- Gentry Manor
- Urban Deca
- Eight Sunet Boulevard
- One Fintech Tower
- Two Mcwest
- Empire East Highlands Mall
- The Hive Tower D



# WHITEPORT INC.

## ONGOING PROJECTS

- 8 Alonzo
- Robinsons Antipolo Expansion
- Glasston
- ILand
- Glass Office Dev't

# MONOLITH

## ONGOING PROJECTS

- Trium
- Sinocan
- Hotel 101
- Sm Grand Central
- Aseana 5



# COMPLETED PROJECTS



SM Aura

# COMPLETED PROJECTS



Alphaland Tower



Net Lima



Eco Tower



# OTHER COMPLETED PROJECTS

- Cyberscape Beta
- Trion Tower 1
- Landcaster Building 2
- Metro Gaisano
- Sm Keppel (BDO Tower 1)
- Anchorland Tower 1 & 2
- Kristong Hari Shrine

## WHITEPORT

- Robinsons Mall (Antipolo)
- Spark Place
- Scape Building
- Robinsons Mall (Las Piñas)
- Shine Residences
- Palm Tree (NewPort)
- Biopolis
- Bellagio One, Two & Three
- Reach

## DDT KONSTRACT

- Trion Tower 2
- BDO Tower
- Solemare Suites 2
- Cyberscape Beta Breeze Residences
- Solemare 1
- Solemare 2
- MOA Expansion 4

## F.F CRUZ

- 78 MLP Bayani Road  
Taguig
- Viaduct
- Pier 10 & 16
- Pipe Laying
- Cavitex/ C5 Link Extension
- Manila North Harbour

## TAKENAKA CORPORATION

- NAIA Terminal 3

# OTHER COMPLETED PROJECTS

## EEI CORPORATION

- Berth 6
- One Central
- Beacon Tower 1
- Beacon Tower 2
- Clipp Center
- CNS
- Sun Residences Tower 1
- CNS - ATM Project
- ADB Project
- Harbour Link
- Sky Suites
- Fame Residences
- Unioil
- Finance Center
- Sun Residences Tower 2
- MWCi Capistrano (Taguig)
- Festival Expansion Mall
- Bocaue
- Uptown Mall
- One Uptown Residences
- Novotel
- Mezza Residences
- Anchor Skysuites
- Mamasita
- One Ecom
- Two Ecom
- Three Ecom
- Pier 16
- Green Residences



# OTHER COMPLETED PROJECTS

## MDC

- East Super Block
- Miranti
- West Tower
- Berlin Hotel
- Red Oak
- Citiflex
- Celadon
- Amaia Skies Avenida
- 34th Street
- Bonifacio Stop Over
- Kidzania Manila
- Serendra Buildings
- Glorietta Malls

## MEGAWORLD

- Legrand Tower 1
- Legrand Tower 2
- Legrand Tower 3
- One Central
- Two Central
- Eight Forbes Town
- Uptown Mall
- One Uptown Residences
- Uptown Park Suites
- Mckinley West
- Venice Grand Canal Mall

## MEGAWIDE CONSTRUCTION CORP.

- Bench Tower (Global)
- Sm Sea Residences
- Blue Residences
- Studio City (Alabang)
- Studio Zen
- One World Place (Global)
- Edades Tower
- Jazz Residences

# OTHER COMPLETED PROJECTS

- Birch Tower
- Maritime Museum
- Green Residences
- Tune Hotel
- Microtel

## **ROYAL PIONEER DEVT. CORPORATION**

- Marina Seaview Phase 3
- Pacific Res
- Lavida
- Jinxi

## **TREVI FOUNDATION**

- Linear (Filinvest)
- Aqua Residences
- Mezza 2 Residences
- Sta Mesa Dormitory
- Kasara Urban Residences
- Pasig Medical Center
- Larossa

## **BAUER FOUNDATION**

- Rochester
- Acqua Residences
- K Line
- Trevi Lauriano
- Ridance

## **ADVANCE FOUNDATION**

- Grand Riviera (Moldex)
- Sky Suites (Anchor Land)
- Oxford Parksuites
- Unihealth
- Supreme Garden
- Monichocam
- Grand Suites
- Torre De Sto. Tomas
- Iglesia
- UST
- Trium Square



# OTHER COMPLETED PROJECTS

## **NATIONAL LIFE INSURANCE & CO.**

- Nex 54 Building

## **NEW GOLDEN CITY BUILDERS**

- City Of Dreams
- Eton Parkview Greenbelt

## **WILL DECENA AND ASSOCIATES, INC.**

- Hop Inn Alabang
- Hop Inn Pasay
- Starmall Taguig
- Lub-D
- Tahanan Ng Mabubuting Pastol
- MCU Hospital
- Sunny Place Residences Phase 1

## **DREAMBUILDERS**

- The Levels

## **BSP & COMPANY**

- Road Restoration

## **MONOLITH CONST. DEV'T CORP.**

- Wils Building  
(Global Taguig)
- Panorama  
(Global Taguig)
- Pearl Tower
- Sla-24/7 Building  
(Global Taguig)
- GSCTower
- Cyberscape Alpha

## **CENTURY PROPERTIES**

- Nex Tower
- Knight Bridge
- Azure
- Acqua
- Commonwealth Residences

## **SOGECOA INTERNATIONAL**

- Sunshine 100
- D' University Tower

# OTHER COMPLETED PROJECTS

## **M.E SICAT**

- UST Project
- MCU - General Hospital
- Quezon City Genera Hospital

## **MGS**

- Currency Tower
- Salcedo Square
- BPO Tower- Shaw Mandaluyong
- Vita Care Alabang

## **ASIA STRUCTURAL**

- Puregold Warehouse (Parañaque)
- Commercial Building (Quezon City)
- S&R (Libis)
- 999 Shopping Mall 1 & 2

## **FREYSSINET**

- Eton Parkview (Greenbelt)
- Wharton Tower
- Mercado Building

## **BETON BAU**

- Aspire Tower

## **TEEP ASIA**

- Field Residences
- Chateau Elysse
- Puregold (Better Living)
- Puregold (Marikina)
- Puregold (Commonwealth)
- Monicocham
- Magnitude

## **STA CLARA INTERNATIONAL**

- STP (Marikina)
- STP (Valenzuela)
- Sewage Pipe Lining
- Cash & Carry



# OTHER COMPLETED PROJECTS

## **VISTALAND & LIFESCAPE, INC.**

- Wil Tower
- Salcedo Square
- Symphony Tower

## **METRO STONERICH, INC.**

- ADB CAR PARK
- Senta Tower
- Will Tower
- PLDT CTC JGSOM building
- Fisher Mall

## **AEON PRIME LAND DEV'T CORP**

- BPO Building (Alabang)
- Polaris

## **DMCI HOMES**

- Asteria
- 21 NWIA
- Vinia
- Lumiere

## **HUAYOU CONSTRUCTION**

- Sunshine Garden
- Oceanaire Condominium

## **BAOYE CONSTRUCTION**

- Gateway Building
- Gateway Parking

## **DATEM**

- Arya Residences
- Net Park
- Trace College
- De La Salle University  
(College Of Law)
- Menarco

## **MILLENIUM ERECTOR CORP. (MEC)**

- Grand Riviera Suites
- Eton Tower

# CURRENT PARTNERS

- **21ST CONSTRUCTION DEV'T.  
CORPORATION**
- **ADVANCE FOUNDATION**
- **ARCHIPELAGO BUILDERS**
- **BAUER FOUNDATION**
- **BISLIG VENTURE**
- **CENTURY PROPERTIES**
- **CHINA CONSTRUCTION  
FRONT GENERAL DEV'T CORP.**
- **DATA LAND**
- **DEVEX INC.**
- **DREAMBUILDERS**
- **FF CRUZ**
- **HILMARCS CONSTRUCTION  
CORPORATION**
- **JQ INTERNATIONAL**
- **MEGAWORLD**
- **MJ LANTRADE**
- **MOLDEX**
- **MONOCRETE  
CONSTRUCTION**
- **NATIONAL LIFE  
INSURANCE & CO.**
- **NEW GOLDEN CITY  
BUILDERS**
- **RESEARCH & DEV'T.  
MANAGEMENT  
CONSTRUCTION INC**
- **SQUARE  
DEVELOPMENT**
- **SUNTRUST PROPERTIES**
- **TERRACON EARTH  
WORKS**
- **VELCOASIA**
- **WILL DECENA  
AND ASSOCIATES INC.**



# HEAD OFFICE ADDRESS



## ADDRESS

14 KM GREENFIELD COMPOUND MERVILLE ACCESS ROAD, BRGY. MERVILLE  
PARANAQUE CITY



## PHONE NUMBER

(02) 478-4200



## EMAIL ADDRESS

[sales.admin@concretemastersinc.com](mailto:sales.admin@concretemastersinc.com)



# BATCHING PLANT ADDRESS

## TAGUIG PLANT



### ADDRESS

AFP-RSBS INDUSTRIAL PARK,  
KM 12 SSH EAST SERVICE  
ROAD CORNER C-5 ROAD,  
WESTERN BICUTAN,  
TAGUIG CITY



### PHONE NUMBER

(02) 837-7777

## MINDANAO PLANT



### ADDRESS

BARANGAY UGONG-UGONG  
MINDANAO AVENUE,  
VALENZUELA CITY



### PHONE NUMBER

0925-6103703





**"MY FOCUS IS TO HAVE THE  
RIGHT PEOPLE DOING THE  
RIGHT THINGS AND BUILDING  
A GREAT WORKING TEAM WITH  
OUR RIGHT PEOPLE."**

FERNANDO L. IMPERIAL, CEO/PRESIDENT





**CONCRETE MASTERS INC.**

